

THIS COPY HAS BEEN MADE BY OR WITH THE AUTHORITY OF SECTION 17 OF THE COPYRIGHT ACT 1968. IT IS NOT TO BE REPRODUCED OR TRANSMITTED IN ANY FORM OR BY ANY MEANS, ELECTRONIC OR MECHANICAL, INCLUDING PHOTOCOPYING, RECORDING, OR BY ANY INFORMATION STORAGE AND RETRIEVAL SYSTEM, WITHOUT THE PRIOR PERMISSION OF THE COPYRIGHT OWNER.

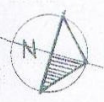

RYEDALE DM
-5 NOV 2015
DEVELOPMENT
MANAGEMENT

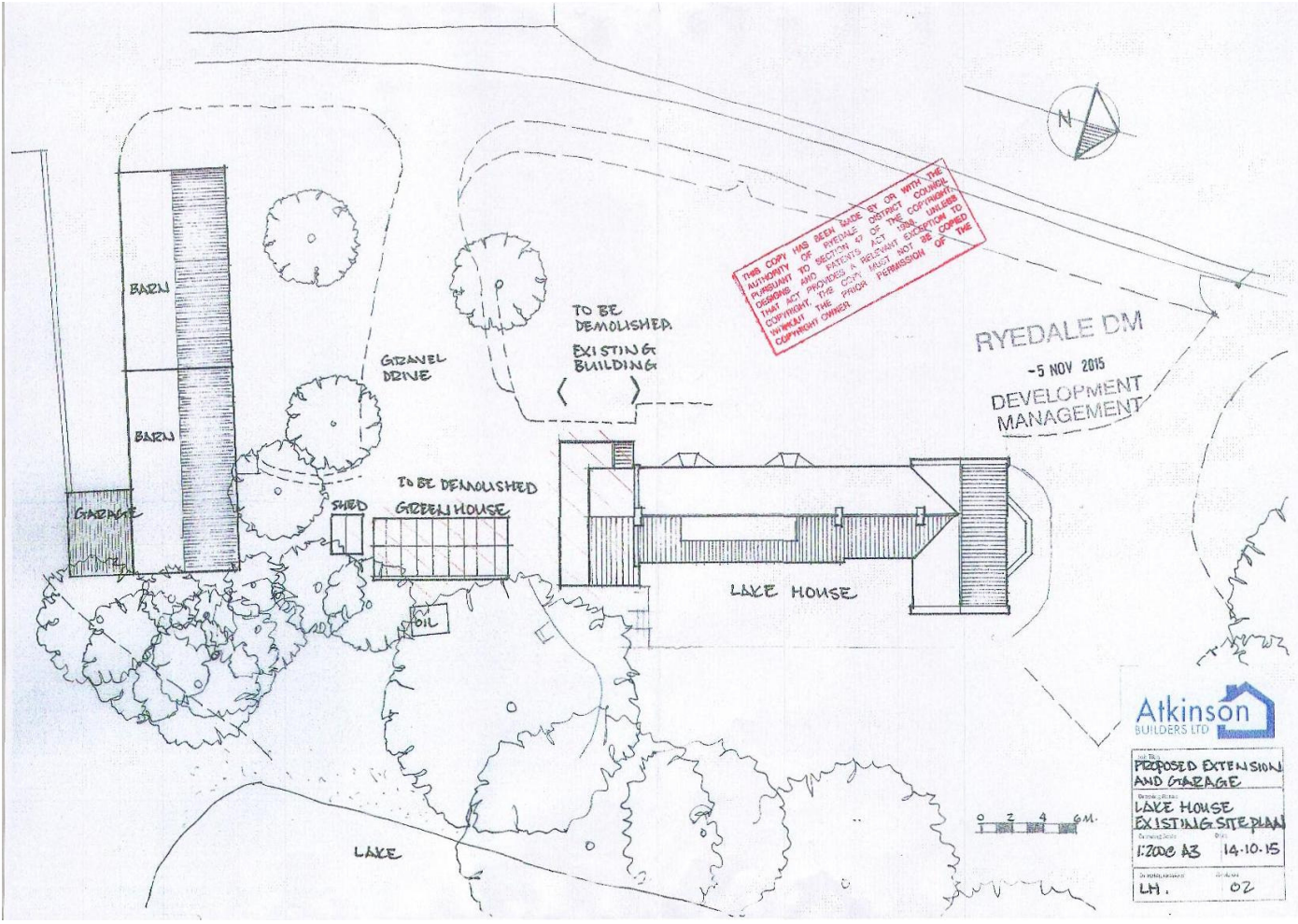

PROPOSED EXTENSION
AND GARAGE
LAKE HOUSE
EXISTING SITE PLAN
1:200 A3 14.10.15
LH: 02



THIS COPY HAS BEEN MADE BY DA WITH THE AUTHORITY OF RYEDALE DISTRICT COUNCIL PURSUANT TO SECTION 10 OF THE COPYRIGHT, DESIGN AND PATENTS ACT 1988. UNLESS THAT ACT PROVIDES A REMEDY IN CONNECTION WITH THIS COPY, THE COUNCIL HAS NOT BEEN COMED BY THE PROVISIONS OF THE COPYRIGHT ACT.

RYEDALE DM
- 5 NOV 2015
DEVELOPMENT
MANAGEMENT

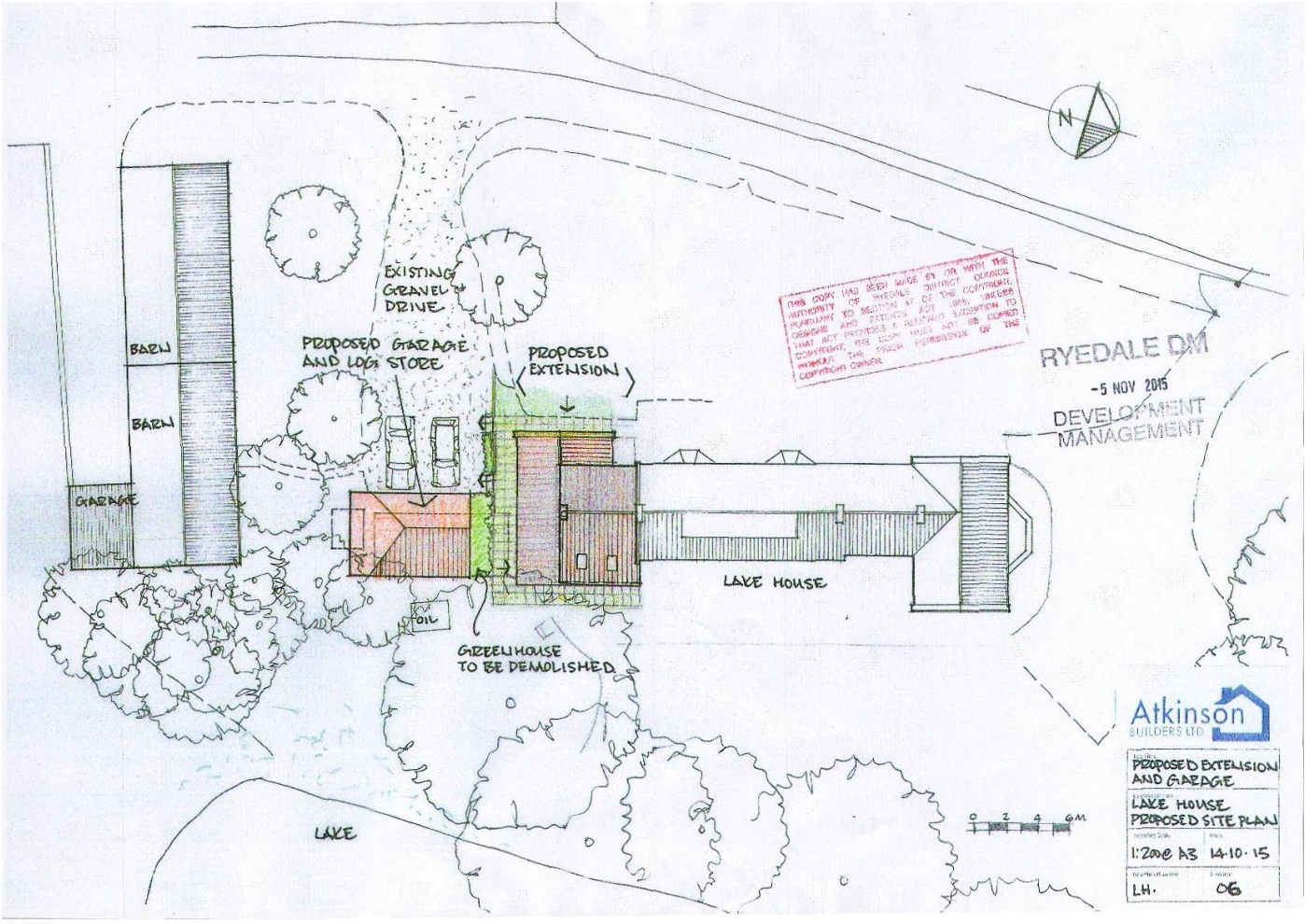

Atkinson
BUILDERS LTD

PROPOSED EXTENSION AND GARAGE

LAKE HOUSE PROPOSED SITE PLAN

DATE: 14-10-15

BY: LH. 06